

LEGEND

- EXISTING SOLID WASTE BOUNDARY
- PHASE LIMITS

NOTE:
 1. 2013 AERIAL PHOTOGRAPH PROVIDED BY AYRES ASSOCIATES, INC. DATE OF PHOTOGRAPHY 03/09/2013.

File: X:\PROJECTS\BLUE RIDGE\120441 - 2013 ANNUAL ASSESSMENT\PROJECT DRAWINGS\0808501-0809-06.dwg User: TodStalman Jan 13, 2015 - 11:06am

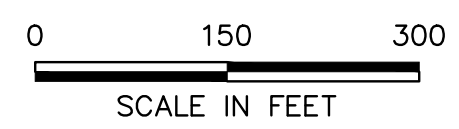

| REV | DATE | DESCRIPTION | DNW BY | DES BY | CHK BY | APP BY |
|-----|------|-------------|--------|--------|--------|--------|
| | | | | | | |
| | | | | | | |
| | | | | | | |

| | | |
|---------------|----------|-------------|
| DATE OF ISSUE | DRAWN BY | CHECKED BY |
| 01/12/15 | JLR | PDL |
| DESIGNED BY | JLR | APPROVED BY |
| | | PDL |



PREPARED BY:
 CORNERSTONE ENVIRONMENTAL GROUP, LLC
This drawing represents intellectual property of Cornerstone Environmental Group LLC. Any modification to the original by other than Cornerstone Environmental Group LLC personnel violates its original purpose and as such is rendered void. Cornerstone Environmental Group LLC will not be held liable for any changes made to this document without express written consent of the originator.

ADVANCED DISPOSAL SERVICES
 BLUE RIDGE RDF
 IRVINE, KENTUCKY

**2013 WASTE PLACEMENT GRID
 SITE PLAN**

SHEET NO.
1
 PROJECT NO.
 120441

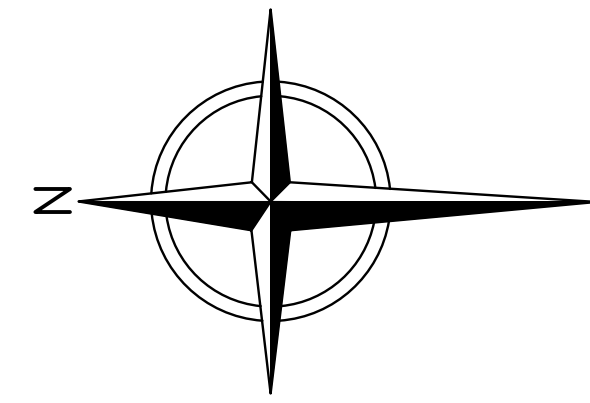
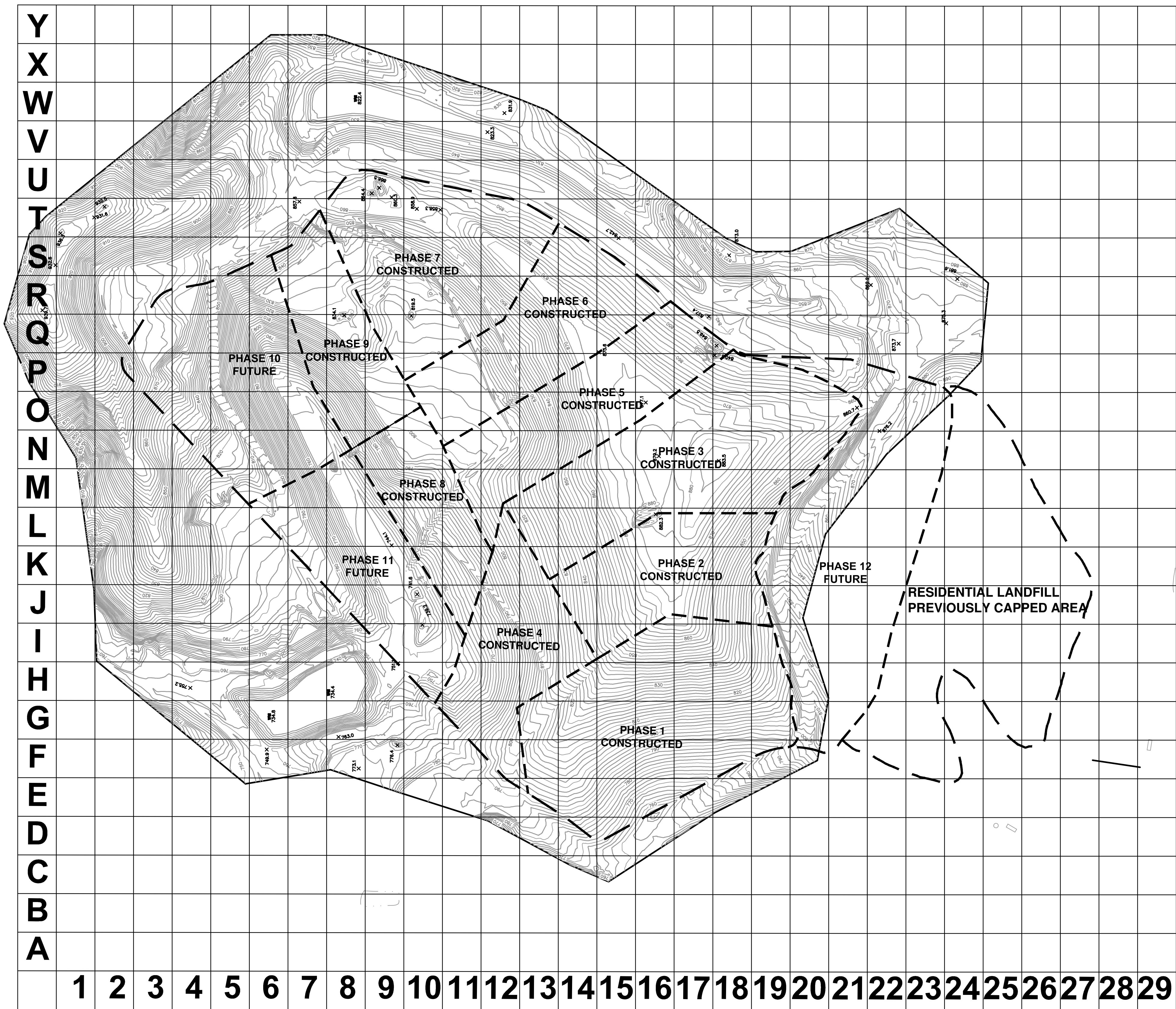

LEGEND

- EXISTING SOLID WASTE BOUNDARY
- PHASE LIMITS

NOTE:
 1. 2013 AERIAL PHOTOGRAPH PROVIDED BY AYRES ASSOCIATES, INC. DATE OF PHOTOGRAPHY 03/09/2013.

File: X:\PROJECTS\BLUE RIDGE\120441 - 2013 ANNUAL ASSESSMENT\PROJECT DRAWINGS\BORDER\120441 - 2013 ANNUAL ASSESSMENT.dwg User: TodStalder Jan 13, 2015 - 11:05am

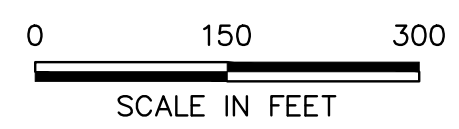

| REV | DATE | DESCRIPTION | DMN BY | DES BY | CHK BY | APP BY |
|-----|------|-------------|--------|--------|--------|--------|
| | | | | | | |
| | | | | | | |

| | | |
|---------------|----------|-------------|
| DATE OF ISSUE | DRAWN BY | CHECKED BY |
| 01/12/15 | JLR | PDL |
| DESIGNED BY | JLR | APPROVED BY |
| | | PDL |

cornerstone
 environmental

PREPARED BY:
 CORNERSTONE ENVIRONMENTAL GROUP, LLC

This drawing represents intellectual property of Cornerstone Environmental Group LLC. Any modification to the original by other than Cornerstone Environmental Group LLC personnel violates its original purpose and as such is rendered void. Cornerstone Environmental Group LLC will not be held liable for any changes made to this document without express written consent of the originator.

ADVANCED DISPOSAL SERVICES
 BLUE RIDGE RDF
 IRVINE, KENTUCKY

**2013 WASTE PLACEMENT GRID
 SITE PLAN**

SHEET NO.
2

PROJECT NO.
 120441

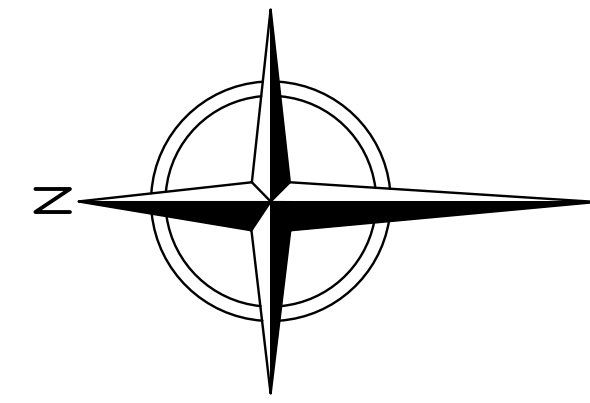

LEGEND

- EXISTING SOLID WASTE BOUNDARY
- PHASE LIMITS

NOTE:
 1. 2013 AERIAL PHOTOGRAPH PROVIDED BY AYRES ASSOCIATES, INC. DATE OF PHOTOGRAPHY 03/09/2013.

File: X:\PROJECTS\BLUE RIDGE\120441 - 2013 ANNUAL ASPENACEL PROJECT DRAWINGS\BORDER\01-aerial-06.dwg Layout: AERIAL_TDS (3) User: TodStidmore Jan 13, 2015 10:47am

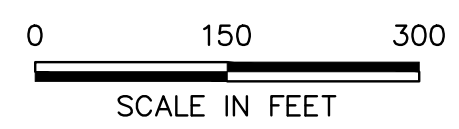

| REV | DATE | DESCRIPTION | DWN BY | DES BY | CHK BY | APP BY |
|-----|------|-------------|--------|--------|--------|--------|
| | | | | | | |
| | | | | | | |

| | | |
|---------------|----------|-------------|
| DATE OF ISSUE | DRAWN BY | CHECKED BY |
| 01/12/15 | JLR | PDL |
| DESIGNED BY | JLR | APPROVED BY |
| | | PDL |

PREPARED BY:
 CORNERSTONE ENVIRONMENTAL GROUP, LLC
This drawing represents intellectual property of Cornerstone Environmental Group, LLC. Any modification to the original by other than Cornerstone Environmental Group, LLC personnel violates its original purpose and as such is rendered void. Cornerstone Environmental Group, LLC will not be held liable for any changes made to this document without express written consent of the originator.

ADVANCED DISPOSAL SERVICES
 BLUE RIDGE RDF
 IRVINE, KENTUCKY

2013 WASTE PLACEMENT GRID
SITE PLAN

SHEET NO.
3
 PROJECT NO.
 120441

BLUE RIDGE LANDFILL COVER REPORT

Month: Dec-15

| Date | Map Grid Location | Number of Loads used for cover | Cubic Yards of Cover | ADC USED (Y or N) | Gate Tons Received | Bottom Waste Elevation | WEATHER CONDITIO N | RAINFALL AMOUNT |
|--------|-------------------|--------------------------------|----------------------|-------------------|--------------------|------------------------|--------------------|-----------------|
| 1 | M-13 | | - | Y | 518.93 | 860 | Rain, 62 | 2.50 |
| 2 | M-12 | 8 | 200 | Y | 393.03 | 860 | Rain, 51 | 1.00 |
| 3 | M-12 | 2 | 50 | Y | 531.25 | 860 | Cloudy, 44 | |
| 4 | M-12 | | - | Y | 599.71 | 860 | Sunny, 49 | |
| 5 | | | - | Y | - | | | |
| 6 | | | - | Y | - | | | |
| 7 | N-13 | 3 | 75 | Y | 509.87 | 860 | Rain, 47 | 0.25 |
| 8 | N-13 | 20 | 500 | Y | 527.47 | 860 | Sunny, 58 | |
| 9 | N-13 | 30 | 750 | Y | 461.00 | 860 | Sunny, 57 | |
| 10 | N-13 | 20 | 500 | Y | 306.98 | 860 | Sunny, 63 | |
| 11 | N-13 | | - | Y | 299.59 | 860 | Sunny, 66 | |
| 12 | | | - | Y | - | | | |
| 13 | | | - | Y | - | | | |
| 14 | N-13 | 36 | 900 | Y | 392.75 | 860 | Sunny, 67 | |
| 15 | N-13 | 26 | 650 | Y | 311.54 | 860 | Rain, 60 | 0.25 |
| 16 | O-13 | 28 | 700 | Y | 398.05 | 860 | Sunny, 70 | |
| 17 | O-13 | 2 | 50 | Y | 403.50 | 860 | Rain, 60 | 0.75 |
| 18 | O-13 | | - | Y | 450.79 | 860 | Sunny, 33 | |
| 19 | | | - | Y | - | | | |
| 20 | | | - | Y | - | | | |
| 21 | O-13 | 2 | 50 | Y | 463.17 | 860 | Rain, 58 | 0.40 |
| 22 | O-13 | | - | Y | 354.41 | 860 | Rain, 62 | 2.00 |
| 23 | O-13 | | - | Y | 454.85 | 860 | Rain, 67 | 0.50 |
| 24 | O-13 | | - | Y | 306.07 | 860 | Rain, 72 | 1.75 |
| 25 | | | - | Y | - | | | |
| 26 | O-13 | | - | Y | 190.55 | 860 | Rain, 68 | 2.25 |
| 27 | | | - | Y | - | | | |
| 28 | O-12 | 7 | 175 | Y | 582.66 | 860 | Rain, 66 | 1.00 |
| 29 | O-12 | 10 | 250 | Y | 675.20 | 860 | Rain, 66 | 0.75 |
| 30 | O-12 | | - | Y | 536.35 | 860 | Sunny, 56 | |
| 31 | O-12 | 19 | 475 | Y | 470.96 | 860 | Sunny, 44 | |
| TOTALS | | | 5,325 | | 10,138.68 | | | 13.40 |