

**LEGEND**

- EXISTING SOLID WASTE BOUNDARY
- PHASE LIMITS

**NOTE:**  
 1. 2013 AERIAL PHOTOGRAPH PROVIDED BY AYRES ASSOCIATES, INC. DATE OF PHOTOGRAPHY 03/09/2013.

File: X:\PROJECTS\BLUE RIDGE\120441 - 2013 ANNUAL ASSESSMENT\PROJECT DRAWINGS\0808501-0809-06.dwg User: TodStalman Jan 13, 2015 - 11:06am

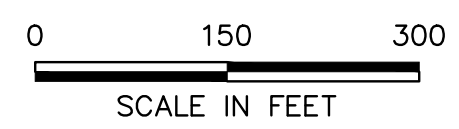

REV	DATE	DESCRIPTION	DNW BY	DES BY	CHK BY	APP BY

DATE OF ISSUE	DRAWN BY	CHECKED BY
01/12/15	JLR	PDL
DESIGNED BY	JLR	APPROVED BY
		PDL



PREPARED BY:  
 CORNERSTONE ENVIRONMENTAL GROUP, LLC  
This drawing represents intellectual property of Cornerstone Environmental Group LLC. Any modification to the original by other than Cornerstone Environmental Group LLC personnel violates its original purpose and as such is rendered void. Cornerstone Environmental Group LLC will not be held liable for any changes made to this document without express written consent of the originator.

ADVANCED DISPOSAL SERVICES  
 BLUE RIDGE RDF  
 IRVINE, KENTUCKY  
  
**2013 WASTE PLACEMENT GRID  
 SITE PLAN**

SHEET NO.  
**1**  
 PROJECT NO.  
 120441

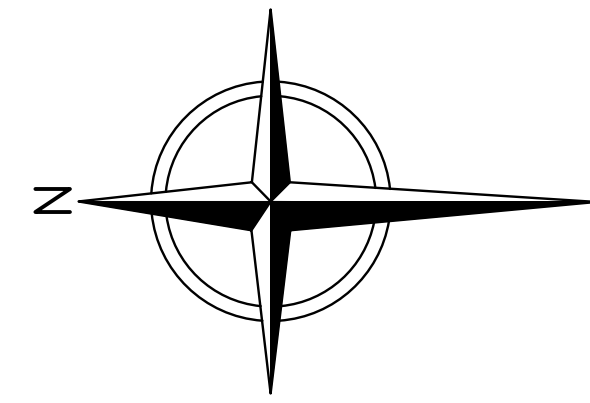
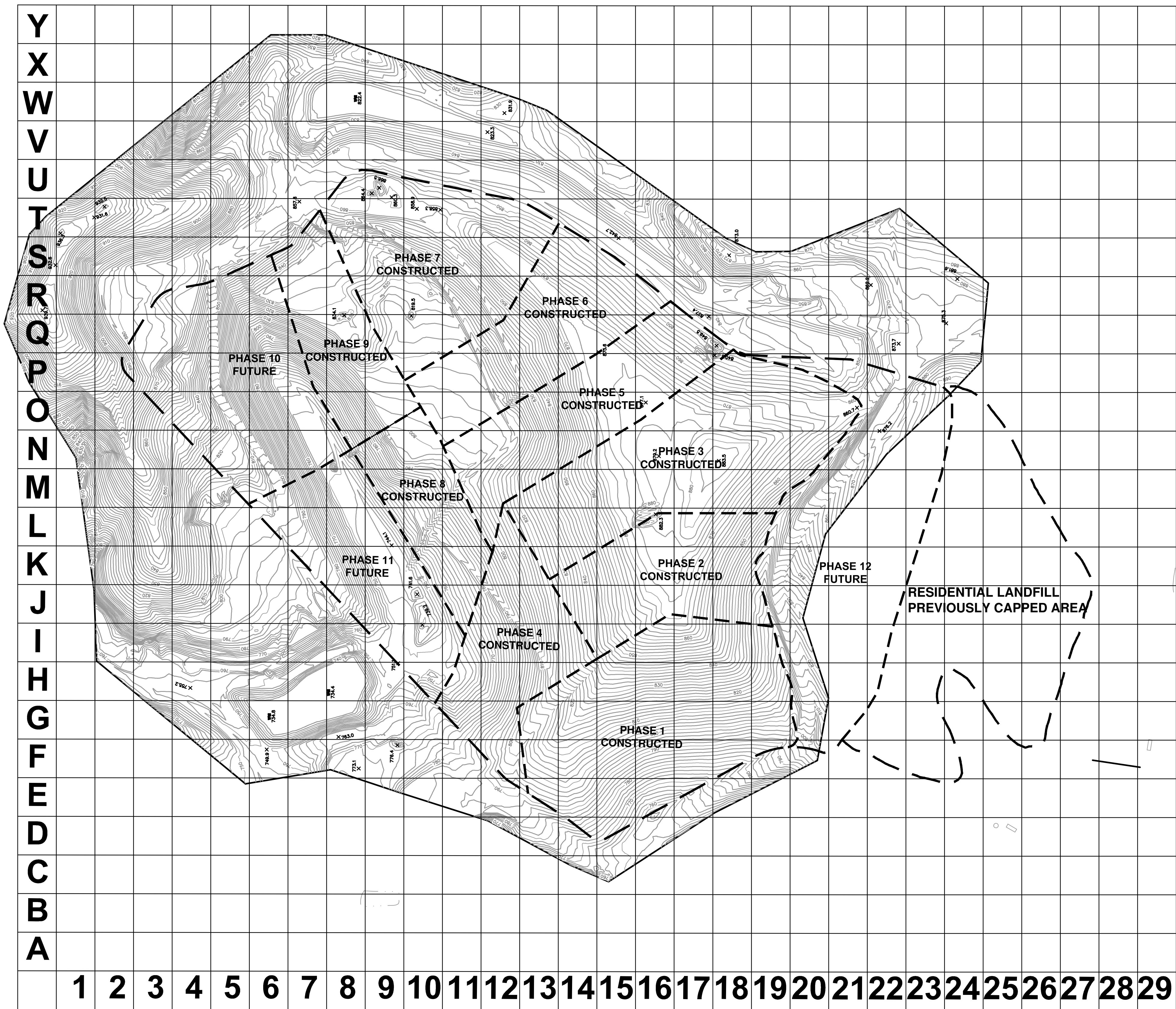

**LEGEND**

- EXISTING SOLID WASTE BOUNDARY
- PHASE LIMITS

**NOTE:**  
 1. 2013 AERIAL PHOTOGRAPH PROVIDED BY AYRES ASSOCIATES, INC. DATE OF PHOTOGRAPHY 03/09/2013.

File: X:\PROJECTS\BLUE RIDGE\120441 - 2013 ANNUAL ASSESSMENT\PROJECT DRAWINGS\BORDER\120441 - 2013 ANNUAL ASSESSMENT.dwg    User: TodStalder    Jan 13, 2015 - 11:05am

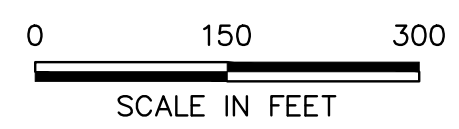

REV	DATE	DESCRIPTION	DMN BY	DES BY	CHK BY	APP BY

DATE OF ISSUE	DRAWN BY	CHECKED BY
01/12/15	JLR	PDL
DESIGNED BY	JLR	APPROVED BY
		PDL

**cornerstone**  
 environmental

PREPARED BY:  
 CORNERSTONE ENVIRONMENTAL GROUP, LLC

This drawing represents intellectual property of Cornerstone Environmental Group, LLC. Any modification to the original by other than Cornerstone Environmental Group, LLC personnel violates its original purpose and as such is rendered void. Cornerstone Environmental Group, LLC will not be held liable for any changes made to this document without express written consent of the originator.

ADVANCED DISPOSAL SERVICES  
 BLUE RIDGE RDF  
 IRVINE, KENTUCKY

**2013 WASTE PLACEMENT GRID  
 SITE PLAN**

SHEET NO.  
**2**

PROJECT NO.  
 120441

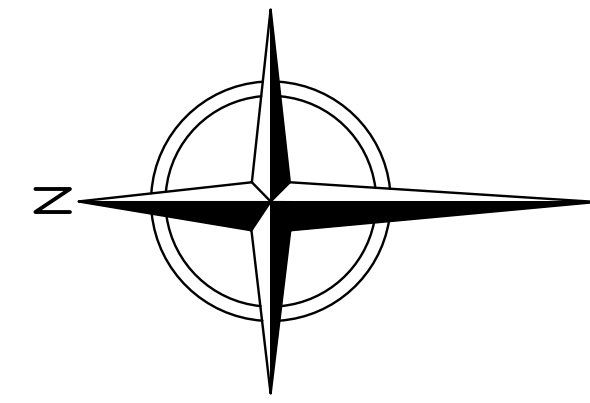

**LEGEND**

- EXISTING SOLID WASTE BOUNDARY
- PHASE LIMITS

**NOTE:**  
 1. 2013 AERIAL PHOTOGRAPH PROVIDED BY AYRES ASSOCIATES, INC. DATE OF PHOTOGRAPHY 03/09/2013.

File: X:\PROJECTS\BLUE RIDGE\120441 - 2013 ANNUAL ASPEN\PROJECT DRAWINGS\BORDER\border-06.dwg Layout: AERIAL\_TDS (3) User: TodStidmore Jan 13, 2015 - 10:47am

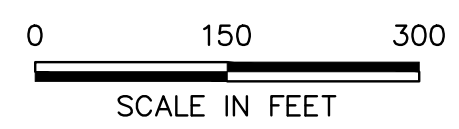

REV	DATE	DESCRIPTION	DWN BY	DES BY	CHK BY	APP BY

DATE OF ISSUE	DRAWN BY	CHECKED BY
01/12/15	JLR	PDL
DESIGNED BY	JLR	APPROVED BY
		PDL

**cornerstone**  
 environmental

PREPARED BY:  
 CORNERSTONE ENVIRONMENTAL GROUP, LLC

This drawing represents intellectual property of Cornerstone Environmental Group, LLC. Any modification to the original by other than Cornerstone Environmental Group, LLC personnel violates its original purpose and as such is rendered void. Cornerstone Environmental Group, LLC will not be held liable for any changes made to this document without express written consent of the originator.

ADVANCED DISPOSAL SERVICES  
 BLUE RIDGE RDF  
 IRVINE, KENTUCKY

**2013 WASTE PLACEMENT GRID  
 SITE PLAN**

SHEET NO.  
**3**

PROJECT NO.  
 120441

## BLUE RIDGE LANDFILL COVER REPORT

Month: Dec-15

Date	Map Grid Location	Number of Loads used for cover	Cubic Yards of Cover	ADC USED (Y or N)	Gate Tons Received	Bottom Waste Elevation	WEATHER CONDITIO N	RAINFALL AMOUNT
1	M-13		-	Y	518.93	860	Rain, 62	2.50
2	M-12	8	200	Y	393.03	860	Rain, 51	1.00
3	M-12	2	50	Y	531.25	860	Cloudy, 44	
4	M-12		-	Y	599.71	860	Sunny, 49	
5			-	Y	-			
6			-	Y	-			
7	N-13	3	75	Y	509.87	860	Rain, 47	0.25
8	N-13	20	500	Y	527.47	860	Sunny, 58	
9	N-13	30	750	Y	461.00	860	Sunny, 57	
10	N-13	20	500	Y	306.98	860	Sunny, 63	
11	N-13		-	Y	299.59	860	Sunny, 66	
12			-	Y	-			
13			-	Y	-			
14	N-13	36	900	Y	392.75	860	Sunny, 67	
15	N-13	26	650	Y	311.54	860	Rain, 60	0.25
16	O-13	28	700	Y	398.05	860	Sunny, 70	
17	O-13	2	50	Y	403.50	860	Rain, 60	0.75
18	O-13		-	Y	450.79	860	Sunny, 33	
19			-	Y	-			
20			-	Y	-			
21	O-13	2	50	Y	463.17	860	Rain, 58	0.40
22	O-13		-	Y	354.41	860	Rain, 62	2.00
23	O-13		-	Y	454.85	860	Rain, 67	0.50
24	O-13		-	Y	306.07	860	Rain, 72	1.75
25			-	Y	-			
26	O-13		-	Y	190.55	860	Rain, 68	2.25
27			-	Y	-			
28	O-12	7	175	Y	582.66	860	Rain, 66	1.00
29	O-12	10	250	Y	675.20	860	Rain, 66	0.75
30	O-12		-	Y	536.35	860	Sunny, 56	
31	O-12	19	475	Y	470.96	860	Sunny, 44	
TOTALS			5,325		10,138.68			13.40